

**DRY POND NOTES:**

1. CONTRACTOR SHALL PROVIDE THE RESULTS OF PERMEABILITY TESTING BY A REGISTERED GEOTECHNICAL ENGINEER IN THE BOTTOM OF ALL DRY DETENTION AREAS AFTER POND CONSTRUCTION & STABILIZATION IS COMPLETE.
2. THE RESULTS OF SUCH TESTING WILL BE PROVIDED TO THE ENGINEER OF RECORD.
3. CONTRACTOR SHALL NOT PLACE SOD ON THE BOTTOM OF DRY RETENTION / DETENTION AREAS, UNLESS THE SOD IS SAND-GROWN SOD AND DOES NOT IMPEDE INFILTRATION.
4. USE OF SAND-GROWN SOD IN THE BOTTOM OF POND 1 AND 2 IS SUBJECT TO APPROVAL BY THE ENGINEER OF RECORD.
5. IF SAND-GROWN SOD MUST BE USED, CONTRACTOR SHALL PROVIDE A SHOP DRAWING / SPECIFICATION FROM THE MATERIAL SUPPLIER TO VERIFY SOIL SUBSTRATE CONTAINS NO ORGANICS, PEAT, SILT, CLAY, ETC. MATERIALS THAT INHIBIT INFILTRATION.
6. SEED AND MULCH OR SOD WILL TYPICALLY BE USED TO STABILIZE THE BOTTOMS OF DRY RETENTION AND DRY DETENTION PONDS.
7. SAND-GROWN SOD SHALL BE USED TO STABILIZE THE SIDE SLOPES OF DRY RETENTION PONDS.
8. ALL PONDS SHALL BE STABILIZED. INVETERATE DRY POND BOTTOMS OR SLOPES WILL NOT BE ACCEPTED.
9. CONTRACTOR SHALL VERIFY THAT SOIL PLACED IN THE SHADED DRY POND AREA(S) HAS THE MINIMUM SPECIFIED VOID RATIO AND PERMEABILITY.

PERMEABILITY	VOID RATIO
POND: 23 FT / DAY (VERTICAL)	20 %
35 FT / DAY (HORIZONTAL)	

**GRADING LEGEND**

EL	ELEVATION		EXISTING PAVEMENT
TYP	TYPICAL		PROPOSED CONCRETE PAVEMENT
C/O	CLEANOUT		PROPOSED CONCRETE SIDEWALK
IE	INVERT ELEVATION		PROPOSED LIGHT DUTY PAVEMENT
SD	STORM DRAIN		PROPOSED HEAVY DUTY PAVEMENT
MEG	EXISTING ELEVATION		DRAINAGE FLOW DIRECTION
MEG	PROPOSED SPOT ELEVATION		
MEG	MATCH EXISTING GRADE		
DI	DRAINAGE INLET		
MEG	MITERED END SECTION		
MEG	SURFACE STORMWATER FLOW		
MEG	FINISH FLOOR ELEVATION		
S/W	SIDEWALK		
(D-15)	STORM SEWER STRUCTURE NUMBER		
TW	TOP OF WALL		
BW	BOTTOM OF WALL		

**GRADING & DRAINAGE NOTES:**

1. ALL SIDEWALKS AND A.D.A. ACCESSIBLE ROUTES ARE TO BE FIELD CHECKED WITH A SMART LEVEL DURING CONSTRUCTION. THE MAXIMUM ADA CROSS SLOPE IS 2%. THE MAXIMUM ADA LONGITUDINAL SLOPE IS 5%. CONTACT AVID GROUP IF THERE ARE ANY QUESTIONS.
2. SOME DRAINAGE STRUCTURES MAY REQUIRE A TYPE "J" OR "P" BOTTOM IN ACCORDANCE TO FDOT STANDARD PLANS INDEX 425-010.

**ALTERNATIVE PIPE MATERIALS NOTES:**

ALTERNATIVE PIPE MATERIALS MAY BE USED AS STORM SEWERS IN LIEU OF RCP, UNDER THE FOLLOWING CONDITIONS:

1. OUTSIDE THE LIMITS OF THE ROADWAY OR PAVED AREAS
2. WITHIN THE PRIVATE ROADWAY OR PAVED AREAS WHEN DEPTH OF COVER MEETS THE REQUIREMENTS OF THE FDOT DRAINAGE MANUAL, APPENDIX E
3. ALTERNATIVE PLASTIC PIPE TYPES INCLUDE:
  - a.) ADS N-12 WT IB HDPE
  - b.) CONTECH A-2000 PVC
  - c.) HANGOR SURE-LOK WT HDPE
4. ALTERNATIVE CONCRETE PIPE INCLUDES ERCP CLASS III.
5. FINAL APPROVAL FOR PIPE MATERIAL SHALL BE AUTHORIZED BY ENGINEER OF RECORD PRIOR TO CONTRACTOR PURCHASING MATERIALS FOR INSTALLATION.
6. MANUFACTURER'S PIPE BEDDING REQUIREMENTS, OR LOCAL JURISDICTIONAL CODE STANDARDS, WHICH EVER ARE GREATER, ARE TO BE INCORPORATED WITH ALTERNATIVE PIPE SELECTION.
7. LOCAL JURISDICTION PIPE MATERIAL RESTRICTIONS WILL GOVERN.

**NPDES NOTES:**

1. PRIOR TO CONSTRUCTION THE CONTRACTOR SHALL PLACE SILT FABRIC FENCE AT THE UPSTREAM END OF ALL STORM SEWER PIPES UNTIL INLETS ARE COMPLETED.
2. WHEN THE CONSTRUCTION OF INLETS ARE COMPLETED THE CONTRACTOR SHALL PLACE SILT FABRIC FENCE IN PLACE AS PER DETAIL.
3. THE CONTRACTOR SHALL SEED AND MULCH OR SOD SWALES AND PONDS PER SECTIONS, IMMEDIATELY AFTER CONSTRUCTION IS COMPLETED AND PROMOTE QUICK REVEGETATION.
4. THE CONTRACTOR SHALL CHECK ALL EROSION AND SILTATION CONTROL DEVICES AFTER EACH RAINFALL AND REPAIR OR REPLACE THEM AS REQUIRED. SILT FENCES TO REMAIN UNTIL CITY/COUNTY ACCEPTANCE.
5. THE REQUIREMENTS LISTED ABOVE SHALL BE CONSIDERED MINIMUM REQUIREMENTS AND THE CONTRACTOR SHALL USE WHATEVER METHODS HE DEEMS NECESSARY TO PREVENT EROSION AND SILTATION AS MAY BE REQUIRED FOR THE PROJECT.
6. DEWATERING METHODS OF WELLPOINTING AND DIRECT BURIAL "SOCK" PIPE SHALL BE UTILIZED.
7. DEWATERING DISCHARGE SHALL BE DIRECTED TO A SEDIMENT SUMP PRIOR TO BEING DISCHARGED OFFSITE.

**GEOTECHNICAL REFERENCE:**

THE GEOTECHNICAL REPORT WAS PREPARED BY ECS FLORIDA, LLC, REPORT NO. 24.6314, DATED 08/06/2018. DESIGN OF THE PROPOSED SITE IMPROVEMENTS HAS CONSIDERED THE RECOMMENDATIONS PROVIDED IN THAT REPORT. ALL SITE CONSTRUCTION SHALL BE COMPLETED IN ACCORDANCE WITH THE CRITERIA SPECIFIED WITHIN THE GEOTECHNICAL REPORT. SHOULD THERE BE A CONFLICT BETWEEN THE SPECIFICATIONS WITHIN THE SITE PLANS & THE GEOTECHNICAL REPORT, THE GEOTECHNICAL REPORT SHALL GOVERN.

**DATUM NOTE:**

ELEVATIONS SHOWN ARE BASED ON NATIONAL GEODETIC SURVEY BENCHMARK "S 505", SAID POINT BEING A SURVEY DISC SET IN TOP OF A CONCRETE MONUMENT AND HAVING AN ELEVATION OF 180.41 FEET, PURSUANT TO THE NORTH AMERICAN VERTICAL DATUM OF 1988 (NAVD88), AS PROVIDED BY "BOUNDARY AND TOPOGRAPHIC SURVEY" PREPARED BY JEREMY H. HALLICK, PSM, OF FARNER, BARLEY, AND ASSOCIATES, INC., DATED 07/26/2018.

Always call 811 two full business days before you dig



NO.	DATE	DESCRIPTION	BY
1	01/23/2019	REVISE PER POLK COUNTY COMMENTS	RMH
2	02/02/2019	REVISE PER CITY OF LAKE WALES, POLK COUNTY, & FOOT	RMH
3	03/14/2019	REVISE PER POLK COUNTY COMMENTS	RMH
4	03/14/2019	REVISE PER POLK COUNTY COMMENTS	RMH
5	03/14/2019	REVISE PER POLK COUNTY COMMENTS	RMH
6	03/14/2019	REVISE PER POLK COUNTY COMMENTS	RMH
7	03/14/2019	REVISE PER POLK COUNTY COMMENTS	RMH
8	03/14/2019	REVISE PER POLK COUNTY COMMENTS	RMH
9	03/14/2019	REVISE PER POLK COUNTY COMMENTS	RMH
10	03/14/2019	REVISE PER POLK COUNTY COMMENTS	RMH

**NORTH AMERICAN DEVELOPMENT GROUP**  
 CIVIL ENGINEERING 605 E ROBINSON ST STE 240  
 LAND SURVEYING 3881 N  
 TRANSPORTATION SURVEYING 3881 N  
 SURVEYING PHONE (407) 248-0595  
 GIS AVIDGROUP.COM



**7-ELEVEN AT NEC OF S. BUCK MOORE RD & SR 60 EAST**  
 CITY OF LAKE WALES, FL

**PAVING, GRADING & DRAINAGE PLAN**

**05**

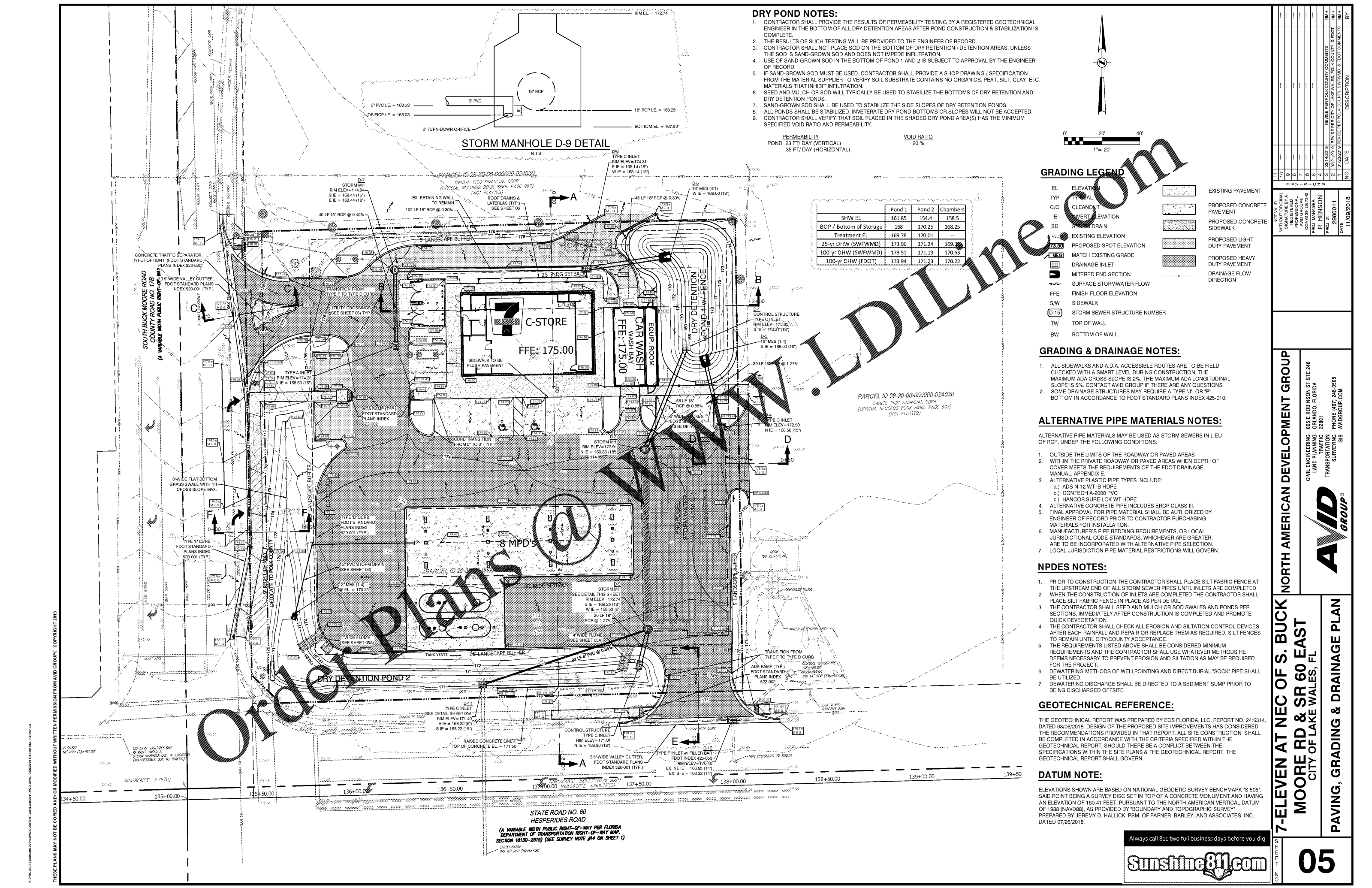

**STORM MANHOLE D-9 DETAIL**

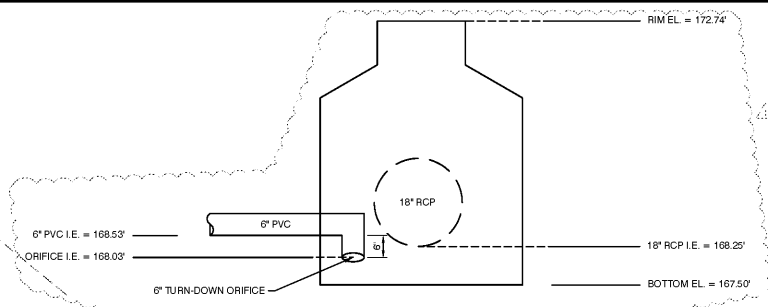

	Pond 1	Pond 2	Chambers
SHW EL	161.85	154.4	158.5
BOP / Bottom of Storage	168	170.25	168.25
Treatment EL	169.78	170.01	---
25-yr DHW (SWFWMD)	173.96	171.24	169.3
100-yr DHW (SWFWMD)	173.51	171.19	170.53
100-yr DHW (FDOT)	173.94	171.23	170.22

Order Plans @ [www.lidilne.com](http://www.lidilne.com)

THESE PLANS MAY NOT BE COPIED AND/OR MODIFIED WITHOUT WRITTEN PERMISSION FROM AVID GROUP. COPYRIGHT 2013

**STATE ROAD NO. 60**  
**HESPERIDES ROAD**  
 (A VARIABLE WIDTH PUBLIC RIGHT-OF-WAY PER FLORIDA DEPARTMENT OF TRANSPORTATION RIGHT-OF-WAY MAP SECTION 16130-2915) (SEE SURVEY NOTE #14 ON SHEET 1)