

Order Plans @ www.WLDIline.com

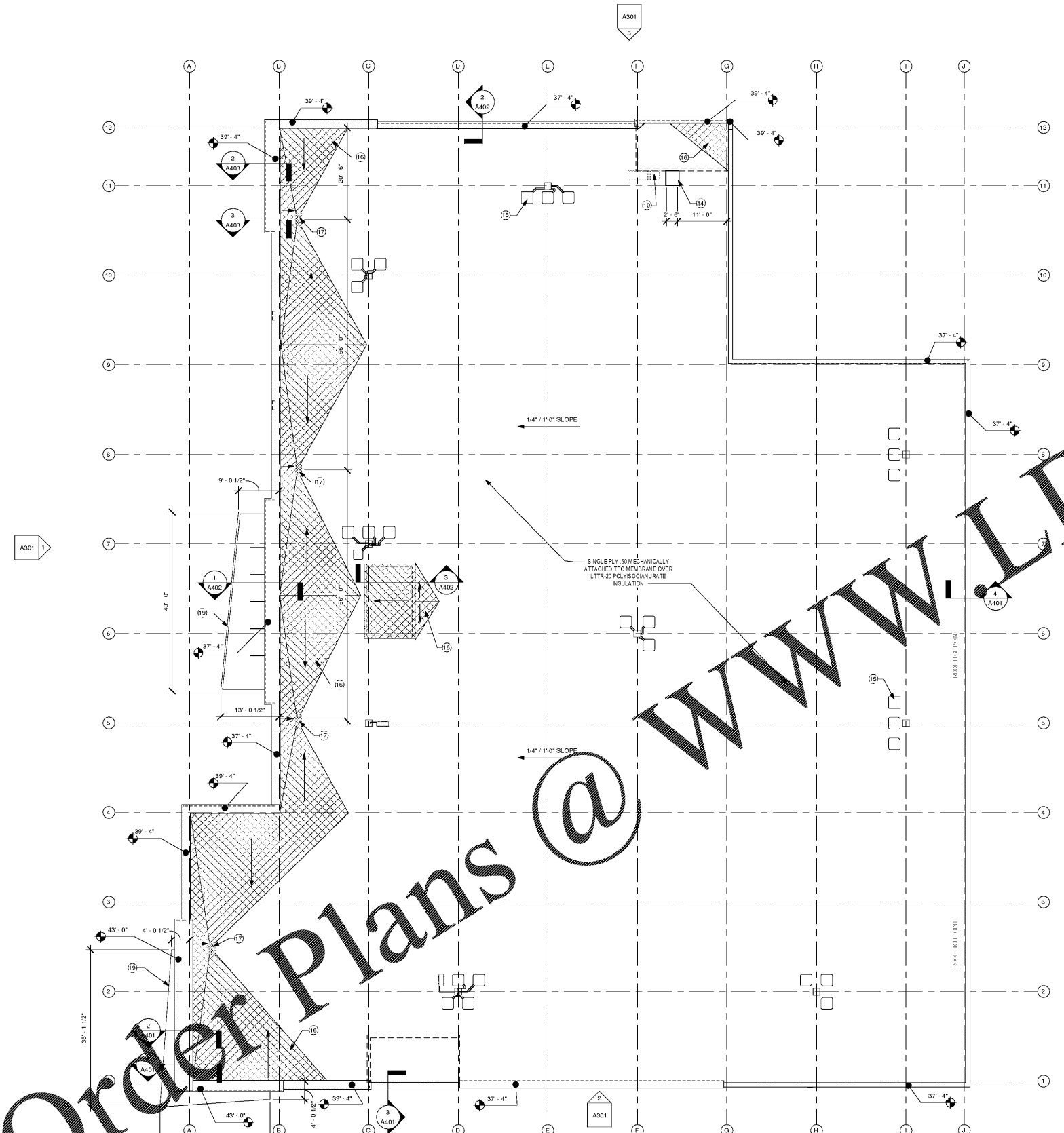

1 ROOF PLAN
SCALE: 3/32" = 1'-0"

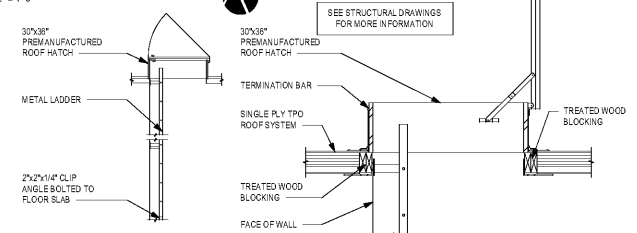

4 ROOF HATCH
SCALE: 1 1/2" = 1'-0"

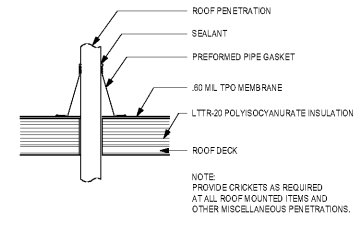

3 TYP. ROOF PENETRATION DETAIL
SCALE: 1 1/2" = 1'-0"

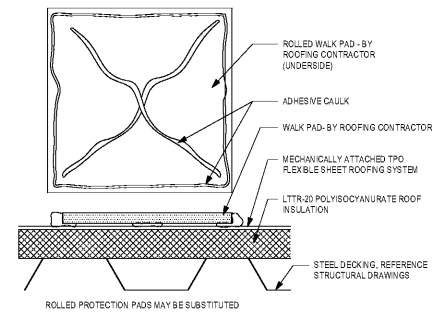

2 WALKWAY PAD DETAIL
SCALE: 12" = 1'-0"

GENERAL NOTES

- A. ALL DIMENSIONS ARE FROM FACE OF FINISH WALL TO FACE OF WALL OR FINISH WALL UNLESS NOTED OR SHOWN OTHERWISE. ANY DIMENSIONS NOT SHOWN OR DEDUCED QUESTIONABLE ARE TO BE VERIFIED BY ARCHITECT. DO NOT SCALE DRAWINGS.
- B. PROVIDE WOOD BLOCKING SUPPORTS AS REQUIRED FOR ALL SURFACE MOUNTED ITEMS.
- C. COORDINATE WORK OF THIS TRADE WITH OTHER TRADES.
- D. NEW DOOR AND FRAME NUMBERS CORRESPOND TO ROOM NUMBERS, WHERE MORE THAN ONE DOOR OCCURS IN A ROOM. IF SUFFICIENT HAS BEEN ADDED (I.E. 103A).
- E. PROVIDE MISCELLANEOUS METAL SUPPORT FOR ALL CEILING SUSPENDED ITEMS.
- F. APPLY SEALANT AT ALL JUNCTURES BETWEEN DIFFERENT MATERIALS (I.E. STOREFRONT AND GYPSUM BOARD).
- G. APPLY SEALANT AT ALL PLUMBING FIXTURES AT JUNCTURE WITH WALL.
- H. APPLY SEALANT AT ALL COUPLER TOPS AND BACK SPLASHES AT JUNCTURE WITH WALL.
- I. ALL STEEL STUDS ARE TO BE BRACED ACCORDING TO MANUFACTURER'S LIMITING HEIGHT LIST.
- J. ALL INTERIOR WALLS SHALL BE MARKED IN PLACE PRIOR TO FRAMING FOR ARCHITECT TO REVIEW.
- K. ALL DOORS MUST BE INSTALLED WITH AT LEAST THE MINIMUM MANEUVERING CLEARANCE AT THE DOOR APPROACH PER THE MOST CURRENT AMERICANS WITH DISABILITIES ACT AND INTERNATIONAL BUILDING CODE.
- L. FLOOR SHALL BE SLOPED SMOOTH LEVEL FOR INSTALLATION OF NEW FLOOR FINISHES AS SHOWN.
- M. ALL FURNITURE & WORK SHALL BE PROVIDED AND INSTALLED BY TENANT.
- N. PROVIDE GYPSONUM BOARD, PLUMBING AND INSULATION ON EXTERIOR WALL IN ALL CONDITIONED AREAS.
- O. FIRE EXTINGUISHERS SHOWN IN ALL AREAS. CONTRACTOR TO OBTAIN NUMBERS, TYPE & LOCATION REQUIRED PER CODE AND CONFIRM WITH OWNER.
- P. PROVIDE SEVERAL PENETRATIONS TO BUILDING FOR CABLE, TV & TELEPHONE. COORDINATE WITH OWNER.
- Q. MECHANICAL EQUIPMENT WITH ROOF WALK WILL NOT BE VISIBLE FROM STREET. IN CASE IT IS VISIBLE, PREMANUFACTURED SCREENING WILL BE INSTALLED PER MANUFACTURER'S STANDARDS.

PLAN NOTES

- KEY
- | KEY | DESCRIPTION |
|-----|---|
| 1 | WALL MOUNTED OR SEMI-RECESSED FIRE EXTINGUISHER CABINET AND FIRE EXTINGUISHER MOUNT TO PAT 454 A.F.F. FIRE EXTINGUISHER TO HAVE MIN. RATING OF 2A10BC FOR EVERY 1000 SQ. FT. OF FLOOR AREA. TRAVEL DISTANCE TO AN EXTINGUISHER SHALL NOT EXCEED 75 FEET. ALL EXTINGUISHERS SHALL BE CONSPICUOUSLY LOCATED AND READILY ACCESSIBLE. THE TOP OF THE EXTINGUISHER SHALL NOT BE MORE THAN 6'0" ABOVE THE FLOOR AND THE BOTTOM OF THE EXTINGUISHER SHALL NOT BE LESS THAN 4" ABOVE THE FLOOR. |
| 2 | ALIGN WALLS. |
| 3 | MERCHANDISE AREA, PROVIDED BY OWNER. |
| 4 | SECURITY MONITOR, PROVIDED BY OWNER. |
| 5 | 6" DIA. CONCRETE FILLED PIPE BOLLARD 4'0" TALL W/ ROUNDED CAP AND PAINTED SAFETY YELLOW. SEE DETAIL ON SHEET TRADE. |
| 6 | JANITOR SINK OR WALL CONTRACTOR TO PROVIDE FIBERGLASS REINFORCED PANEL FROM TOP OF SINK TO BOTTOM OF FAUCET ON BOTH WALLS ADJACENT TO SINK. PROVIDE 3/4" LONG FLEXIBLE HOSE AND HOSE CLAMP. SEE PLUMBING DRAWINGS FOR ADDITIONAL INFORMATION. |
| 7 | WATER HEATER LOCATION. SEE PLUMBING DRAWINGS. |
| 8 | H/O DRINKING FOUNTAINS. SEE PLUMBING DRAWINGS. |
| 9 | ROOF ACCESS LADDER - GALVANIZED PAINTED PL. VERTICAL LADDER W/ 1 1/2" X 2 1/2" FLAT BAR WALK 2" APART W/ 1" X 1" WOOD SPLICES AT 2' O.C. AT LEAST 7' CLEAR FROM THE WALL. ANCHOR WITH W/ 1/2" X 2 1/2" L-SHAPED FLAT BAR AT 4' O.C. MAXIMUM. GALVANIZED. |
| 10 | 2X2 OR ROLLED WALKWAY PROTECTION, LAYOUT TO AND AROUND ROOFTOP EQUIPMENT. SEE DETAIL TRADE. |
| 11 | ELECTRICAL PANEL LOCATION. SEE ELECTRICAL DRAWINGS. |
| 12 | WALL PAD. SEE ELECTRICAL DRAWINGS. |
| 13 | 4X8X1/4" PLYWOOD FIRE-TREATED PHONE BOARD. PAINT ALL 6 SIDES TO MATCH ADJACENT WALL. SEE ELECTRICAL DRAWINGS. |
| 14 | ROOF HATCH - 30X36" BY 8 LOG. ALIGN WITH CMU BELOW. COORDINATE WITH STRUCTURAL DRAWINGS. SEE DETAIL TRADE. |
| 15 | ROOFTOP CONDENSING UNITS. SEE MECHANICAL DRAWINGS. |
| 16 | TAPERED INSULATION CRICKET TO ACHIEVE POSITIVE DRAINAGE. |
| 17 | COMBINATION ROOF AND OVERFLOW DRAIN. INSTALL PER MANUFACTURER'S INSTRUCTIONS. SEE PLUMBING DRAWINGS. |
| 18 | GALVALUME PANEL. PER STORAGE UNIT MANUFACTURER. |
| 19 | PRE-ENGINEERED PREFINISHED ALUMINUM CANOPY. |
| 20 | PROPOSED FIRE RISER LOCATION. |
| 21 | SERVER DATA LOCATION. PROVIDED BY OWNER. |
| 22 | PROPOSED SIGN LOCATION. TO BE PERMITTED SEPARATELY. |
| 23 | ROOF DRAIN OVERFLOW LAMB'S TONGUE. LOCATE MIN. 12" ABOVE GRADE. SEE PLUMBING DRAWINGS. |
| 24 | ROOF DRAIN CLEANOUT ACCESS COVER. LOCATE MIN. 12" ABOVE GRADE. SEE PLUMBING DRAWINGS. |
| 25 | WALL LOUVER OR EXHAUST FAN. SEE MECHANICAL DRAWINGS. |
| 26 | 2" SIF REVEAL. |
| 27 | MASONRY CONTROL JOINT. SEE STRUCTURAL DRAWINGS. |

ROOF NOTES:

- MECHANICALLY ATTACHED .60 M.L. TPO FLEXIBLE SHEET ROOFING SYSTEM.
- ⊗ TAPERED ROOF INSULATION.

- A. ALL AREAS TO RECEIVE LTR-20 POLYISOCYANURATE ROOF INSULATION.
- B. CONTRACTOR TO REVIEW AS CONSTRUCTED CONDITIONS AND CONFIRM INSULATION AS SHOWN WILL PROVIDE POSITIVE DRAINAGE IN ALL AREAS.

OWNER:
MC LAND COMPANY LLC.
4116 OUTER DRIVE
NASHVILLE, TN 37204
TEL: 615.578.0845



ARCHITECTURE
135 W Central Blvd., Suite 340
Orlando, Florida 32801
TEL: 407.363.6136
AUGUST 1997

Revised:

Scale	AS NOTED	Date	Drawn By	Author	Contractor	Checker
		04/04/2019				

BOX STORAGE
SELF STORAGE
2100 HAMILTON PLACE BLVD.
CHATTAHOOCHEE, TN 37421

ROOF PLAN AND DETAILS

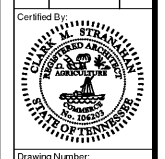

Certified By:
A205
Of Sheets
Job Number:
A/E Job Number:
18356