

LEGEND FOR PROPOSED IMPROVEMENTS

- - - - - PROPERTY LINE / R.O.W.
- ▭ PROPOSED BUILDING
- ▬ PROPOSED CURB AND GUTTER
- ⑫ PROPOSED PARKING SPACES
- PROPOSED FENCING
- SYSL/4" - SINGLE YELLOW SOLID LINE / 4 INCH THICK
- DYSL/5" - DOUBLE YELLOW SOLID LINE / 5 INCH THICK
- SWSL/24" - SINGLE WHITE SOLID LINE / 24 INCH THICK
- SWSL/6" - SINGLE WHITE SOLID LINE / 6 INCH THICK
- SWSL/4" - SINGLE WHITE SOLID LINE / 4 INCH THICK
- SWDL/4" - SINGLE WHITE DASHED LINE / 4 INCH THICK

EXISTING LEGEND

- - - - - APPARENT PROPERTY LINE
- - - - - APPARENT RIGHT-OF-WAY LINE
- - - - - APPARENT EASEMENT/SERVITUDE LINE
- - - - - CONTOUR LINE WITH ELEVATION LABEL
- - - - - WATER LINE
- - - - - OVERHEAD ELECTRIC LINE
- - - - - NATURAL GAS LINE (TYPE & SIZE UNKNOWN)
- - - - - GRAVITY FLOW SANITARY SEWER LINE (TYPE & SIZE AS INDICATED)
- - - - - UNDERGROUND ELECTRIC LINE
- - - - - UNDERGROUND TELEPHONE LINE
- - - - - WOODS EDGE
- - - - - LIGHT POLE
- - - - - UTILITY POLE
- - - - - GUY ANCHOR
- - - - - TELEPHONE PEDESTAL
- - - - - SANITARY SEWER MANHOLE
- - - - - GAS METER
- - - - - SIGNAGE (TYPE AS INDICATED)
- - - - - FIRE HYDRANT
- - - - - WATER LINE VALVE
- - - - - SANITARY SEWER CLEANOUT
- - - - - MAILBOX
- - - - - REINFORCED CONCRETE PIPE
- - - - - POLYETHYLENE GLYCOL
- - - - - SEWER MANHOLE
- - - - - FINISHED FLOOR ELEVATION
- - - - - SPOT ELEVATION
- - - - - ASPHALT SURFACE
- - - - - GRAVEL SURFACE
- - - - - CONCRETE SURFACE

PROPOSED ADDITION SITE ANALYSIS

LOVE'S TRAVEL STOP	10,080± SFex + 412 PROPOSED
TIRE SHOP	10,701± SF PROPOSED
TOTAL SITE AREA	7.65+25.00 = 32.65± ACRES
ZONING	< no zoning >
PARKING PROVIDED -	AUTO ACC RV TRUCK TOTAL SPACES
EXISTING PARKING	51 3 3 64 121
EXPANDED PARKING	48 3 3 101 155

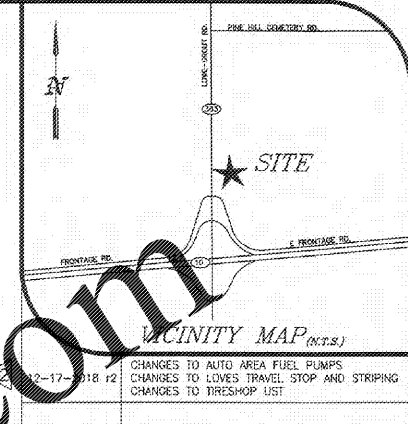

RC 161101

file: 161101.dwg
drawn: DMT
date: 12-17-2018

RESOURCECONSULTING
CIVIL ENGINEERING
6700 Jefferson Highway - Resource Suite 4A
Baton Rouge, LA 70805
Resourceconsulting@hotmail.com
Tel: (225) 761-5909, Fax: (225) 766-6672

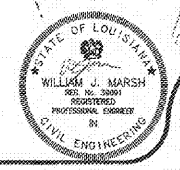
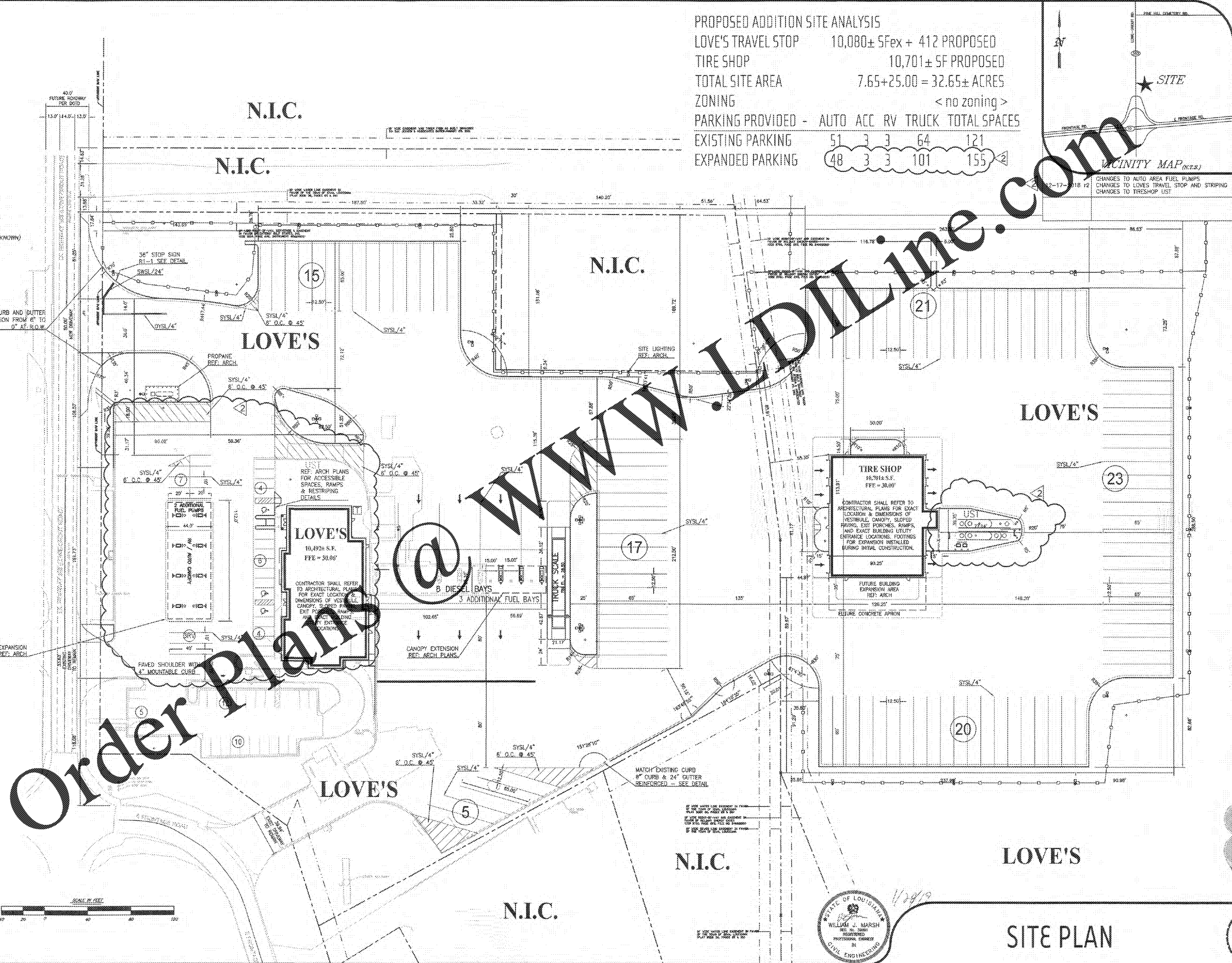

SITE PLAN

C-1

Order Plans

3:01 - swws, LA Exp Love's 1-13 08/143 @ HWY 43 @ HWY 353 RECD Design 161101.dwg 12/28/2018 1:55:39 PM, Outwin, copyright Resource Consulting, LLC



LOVE'S TRAVEL STOP EXPANSION
INTERSTATE 10 EXIT 43 @ HIGHWAY 383
IOWA, LOUISIANA

