

LEGEND FOR PROPOSED IMPROVEMENTS

- PROPERTY LINE / R.O.W.
- ▬ PROPOSED BUILDING
- ▬ PROPOSED CURB AND GUTTER
- ▬ PROPOSED INLET
- ▬ PROPOSED CURB INLET
- ▬ PROPOSED STORM SEWER
- 12.10 PROPOSED ELEVATION

EXISTING LEGEND

- APPARENT PROPERTY LINE
- APPARENT RIGHT-OF-WAY LINE
- APPARENT EASEMENT/SERVITUDE LINE
- CONTOUR LINE WITH ELEVATION LABEL
- WATER LINE
- OVERHEAD ELECTRIC LINE
- NATURAL GAS LINE (TYPE & SIZE UNKNOWN)
- GRAVITY FLOW SANITARY SEWER LINE (TYPE & SIZE AS INDICATED)
- UNDERGROUND ELECTRIC LINE
- UNDERGROUND TELEPHONE LINE
- WOODS EDGE
- LIGHT POLE
- UTILITY POLE
- GUY ANCHOR
- TELEPHONE PEDESTAL
- SANITARY SEWER MANHOLE
- GAS METER
- SIGNAGE (TYPE AS INDICATED)
- FIRE HYDRANT
- WATER LINE VALVE
- SANITARY SEWER CLEANOUT
- MAILBOX
- REINFORCED CONCRETE PIPE
- POLYETHYLENE GLYCOL PIPE
- SEWER MANHOLE
- FINISHED FLOOR ELEVATION
- SPOT ELEVATION
- ASPHALT SURFACE
- GRAVEL SURFACE
- CONCRETE SURFACE

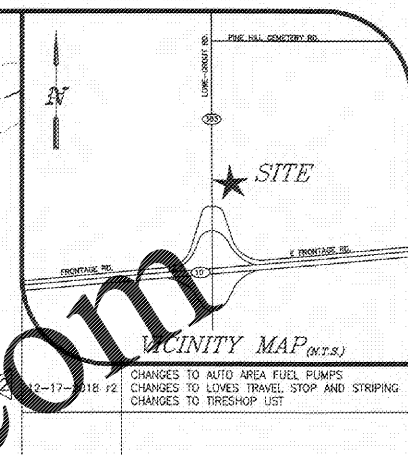
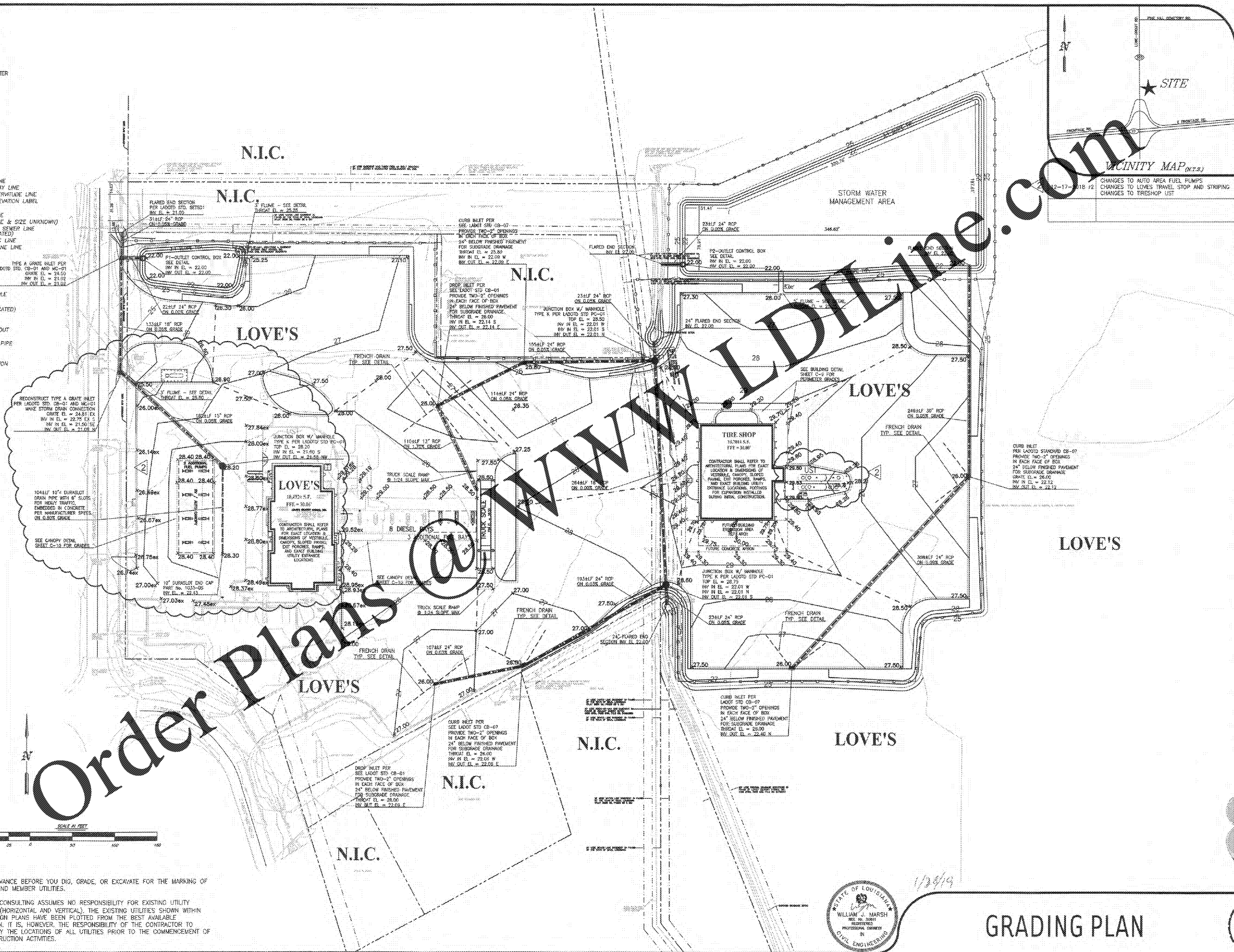

RC161101
 File: 161101v02r2
 Drawn: DMT
 Date: 12-17-2018

RESOURCECONSULTING
 CIVIL ENGINEERING
 6700 Jefferson Highway - Resource Suite 4A
 Baton Rouge, LA 70805
 Resourceconsulting@hotmail.com
 Tel: (225) 761-9900, Fax (225) 766-6672

LOVE'S TRAVEL STOP EXPANSION
 INTERSTATE 10 EXIT 43 @ HIGHWAY 383
 IOWA, LOUISIANA

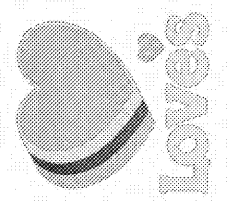

GRADING PLAN

C-3

Order Plans @

WWW.LDLINE.COM

CALL IN ADVANCE BEFORE YOU DIG, GRADE, OR EXCAVATE FOR THE MARKING OF UNDERGROUND MEMBER UTILITIES.

RESOURCE CONSULTING ASSUMES NO RESPONSIBILITY FOR EXISTING UTILITY LOCATIONS (HORIZONTAL AND VERTICAL). THE EXISTING UTILITIES SHOWN WITHIN THESE DESIGN PLANS HAVE BEEN PLOTTED FROM THE BEST AVAILABLE INFORMATION. IT IS, HOWEVER, THE RESPONSIBILITY OF THE CONTRACTOR TO FIELD VERIFY THE LOCATIONS OF ALL UTILITIES PRIOR TO THE COMMENCEMENT OF ANY CONSTRUCTION ACTIVITIES.



I:\01 - Iowa, IA Exp Love's-11-10 revr-43 @ HWY 383 NECD\Design\161101\43.dwg, 12/17/2018 12:55:49 PM, D:\iowa, copyright Resource Consulting, LLC