

Order Plans @ [www.dline.com](mailto:www.dline.com)

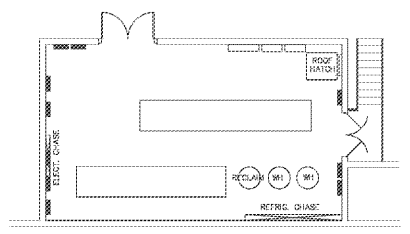

MEZZANINE  
NEW WORK FIXTURE PLAN  
SCALE: 1/8" = 1'-0"

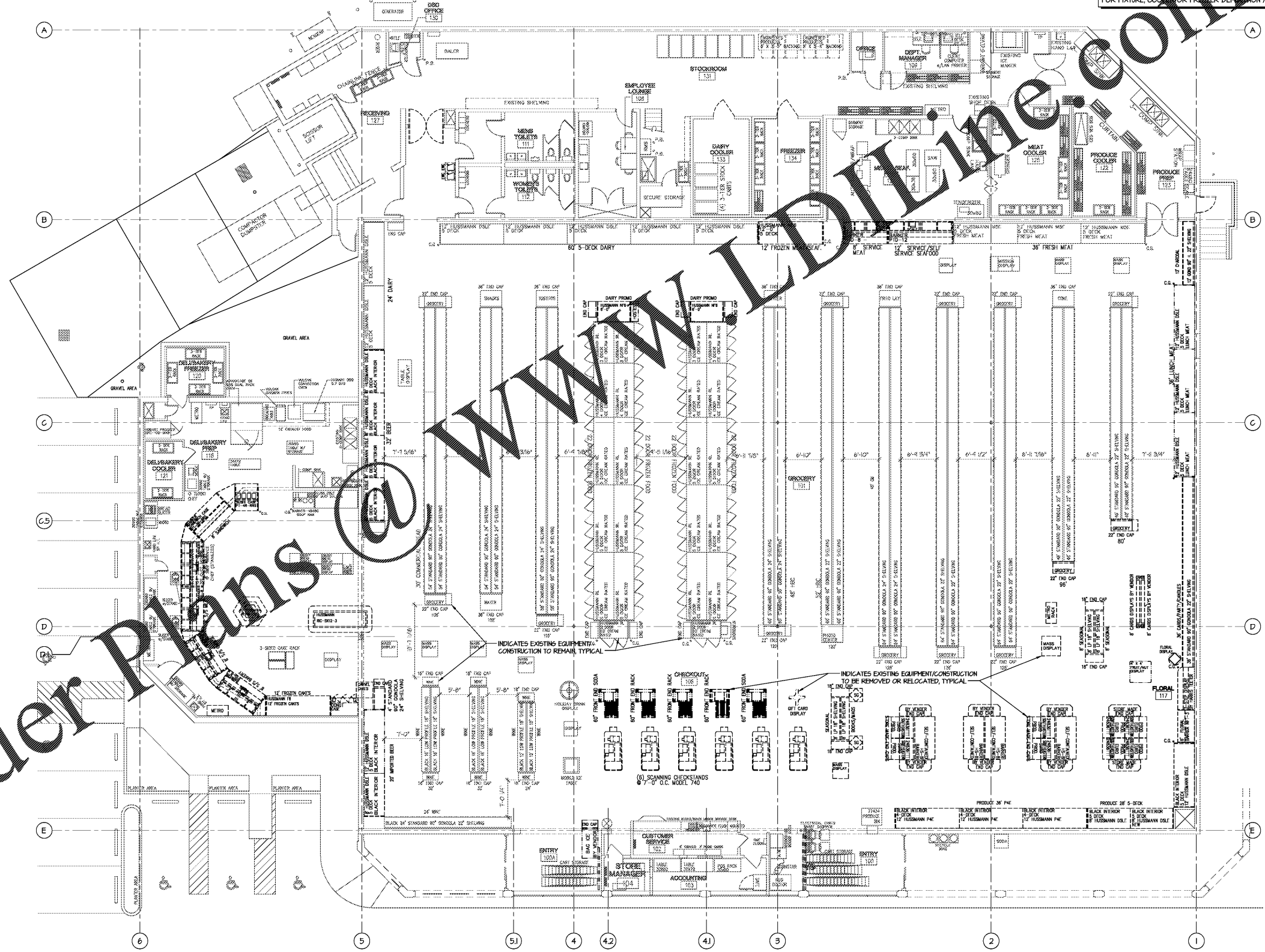

GENERAL CONSTRUCTION SEQUENCE GUIDELINES

- 1. PRIOR TO BIDDING AND THE START OF CONSTRUCTION THE CONTRACTOR SHALL VISIT THE SITE TO VERIFY EXISTING CONDITIONS.
2. THE ORDER AND SEQUENCE OF ALL DEMOLITION AND NEW WORK SHALL BE COORDINATED AND FINALIZED WITH HARRIS TEETER'S PROJECT MANAGER PRIOR TO THE START OF ANY WORK.
3. HARRY RELOCATE EXISTING EQUIPMENT IF REQUIRED, AND CONSTRUCT TEMPORARY BARRICADES TO ALLOW DEMOLITION WORK.
4. THE TIME AND SEQUENCE OF ALL DEMOLITION AND NEW WORK SHALL BE AS DETERMINED BY THE HARRIS TEETER PROJECT MANAGER.
5. REMOVE FROM STORE ALL EQUIPMENT NOT NEEDED FOR REMODEL, EXCEPT FOR P.O.S. EQUIPMENT.
6. FURNISH ONE 30 YARD DUMPSTER FOR STORE TO REMOVE ANY UNWANTED SUPPLIES, EQUIPMENT, ETC.

NOTE: THE REFRIGERATION INSTALLATION CONTRACTOR (R.I.C.) SHALL BE RESPONSIBLE FOR THE DEMOLITION OF ALL FIXTURES ITEMS INDICATED TO BE REMOVED INCLUDING COOLER AND/OR FREEZER CONSTRUCTION. SEE THE REFRIGERATION SPECS. THE GC SHALL REMOVE ANY FOUNDING CONSTRUCTION, WALLS, UTILITIES AND ASSOCIATED BURDENS AS REQUIRED FOR FIXTURE, COOLER OR FREEZER DEMOLITION / REMOVAL.

Design and Construction Documents are the property of Bondurant Associates, Inc. and shall not be used for any other project without the written consent of Bondurant Associates, Inc. This document may be reproduced, in whole or in part, for any means without the written permission of Bondurant Associates.

Table with columns for Date (SEPTEMBER 10, 2019), Job No. (1922), and Revisions (No., Date, Description).



Harris Teeter Neighborhood Food & Pharmacy logo.

Project: HARRIS TEETER STORE #289 - REMODEL
2603 GLENWOOD AVENUE, SUITE 101
RALEIGH, NC 27608
The EXISTING CONDITIONS / DEMOLITION FIXTURE PLAN

NEW WORK FIXTURE PLAN SCALE: 1/8" = 1'-0"