

BASIS OF DESIGN:
 SYSTEM: WL-1049
 MANUFACTURER: SPECIFIED TECHNOLOGIES INC.
 FIRESTOP SEALANT: 5/8" SSS SEALANT
 F-RATING: 1/2 HR
 PRIMARY PRODUCT USED: SSS SEALANT
 SEALING METHOD: CAULK & WALK

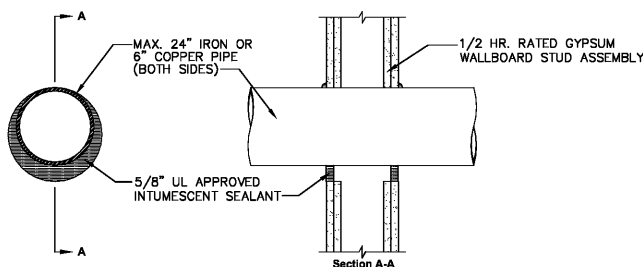

TYPICAL GYPSUM BOARD WALL FIRESTOP SYSTEM (METAL)
 NO SCALE

BASIS OF DESIGN:
 SYSTEM: CAJ-1080
 MANUFACTURER: SPECIFIED TECHNOLOGIES INC.
 FIRESTOP SEALANT: 1" SSS SEALANT
 F-RATING: 3 HR
 PRIMARY PRODUCT USED: SSS SEALANT
 SEALING METHOD: CAULK & WALK

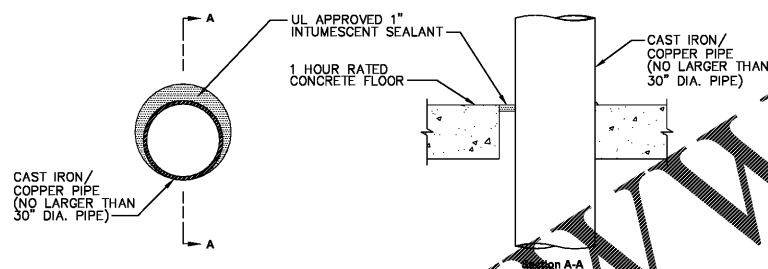

TYPICAL CONCRETE FLOOR WALL FIRESTOP SYSTEM (METAL)
 NO SCALE

BASIS OF DESIGN:
 SYSTEM: CAJ-1080
 MANUFACTURER: SPECIFIED TECHNOLOGIES INC.
 FIRESTOP SEALANT: 1" SSS SEALANT
 F-RATING: 3 HR
 PRIMARY PRODUCT USED: SSS SEALANT
 SEALING METHOD: CAULK & WALK

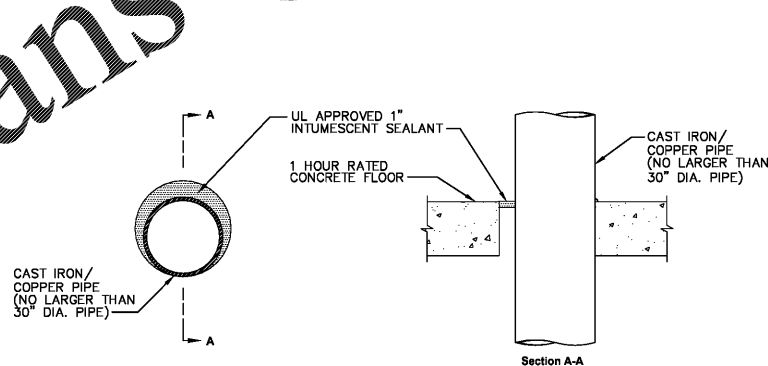

TYPICAL CONCRETE FLOOR/WALL FIRESTOP SYSTEM (METAL)
 NO SCALE

| SYMBOL | DESCRIPTION | ABBREV. |
|----------|---------------------------------------|---------|
| ---CD--- | CONDENSATE DRAIN | CD |
| ---ST--- | STORM BELOW SLAB | ST |
| ---SD--- | SECONDARY EMERGENCY ROOF DRAINAGE | SD |
| ---S--- | SANITARY SEWER BELOW SLAB | S |
| ---OW--- | OIL WASTE | OW |
| ---GW--- | GREASE WASTE | GW |
| ---V--- | VENT PIPING | V |
| --- | COLD WATER PIPING | C.W. |
| --- | HOT WATER PIPING | H.W. |
| --- | HOT WATER RECIRCULATING | H.W.R. |
| --- | GAS PIPING | G |
| --- | COMPRESSED AIR PIPING | A |
| --- | DIRECTION OF FLOW | |
| --- | SWING CHECK VALVE | |
| --- | SHUTOFF VALVE | |
| --- | SOLENOID VALVE | |
| --- | BALANCING VALVE | |
| --- | PRESSURE REGULATING VALVE | |
| --- | ELBOW TURNED DOWN | |
| --- | ELBOW TURNED UP | |
| --- | TURNED DOWN | |
| --- | TURNED UP | |
| --- | TEE TURNED DOWN | |
| --- | TEE TURNED UP | |
| WCO | WALL CLEANOUT | WCO |
| FCO | FLOOR CLEANOUT | FCO |
| CO | EXTERIOR CLEANOUT | C.O. |
| --- | VENT THROUGH ROOF | VTR |
| --- | FLOOR DRAIN | F.D. |
| --- | FLOOR DRAIN | F.D. |
| --- | HUB DRAIN | H.D. |
| --- | HOSE BIB | H.B. |
| --- | FLOOR SINK | F.S. |
| --- | ROOF DRAIN ABOVE | R.D. |
| --- | T&P RELIEF VALVE (AGA RATED) | |
| --- | CONNECT TO EXISTING UTILITIES | |
| --- | WATER HAMMER ARRESTOR | |
| --- | INSERT INDICATES DETAIL NUMBER | |
| --- | INSERT INDICATES SHEET NUMBER | |
| --- | INSERT INDICATES RISER NUMBER | |
| --- | INSERT INDICATES SHEET NUMBER | |
| --- | INSERT INDICATES ENLARGED PLAN NUMBER | |
| --- | INSERT INDICATES SHEET NUMBER | |
| --- | BY PLUMBING CONTRACTOR | |
| --- | REFER TO CIVIL PLANS FOR CONTINUATION | |
| --- | SHUT-OFF VALVE IN VALVE BOX | |
| --- | INSERT INDICATES INVERT ELEVATION | I.E. |
| --- | TRAP PRIMER | TP |
| --- | ABOVE FINISHED FLOOR | A.F.F. |
| --- | CONTINUATION | CONT. |
| --- | DISHWASHER | DW |
| --- | WASHER | W |
| --- | DRAWING | DWG |
| --- | NOT TO SCALE | N.T.S. |
| --- | RAIN WATER LEADER | RWL |
| --- | VENT THROUGH ROOF | VTR |
| --- | FROM BELOW | FB |
| --- | FROM ABOVE | FA |
| --- | BELOW FLOOR | BF |
| --- | BELOW GRADE | BG |
| --- | WATER FIXTURE UNIT | W.F.U. |
| --- | DRAINAGE FIXTURE UNIT | D.F.U. |
| --- | EXISTING CONDITION | (E) |

- ### PLUMBING GENERAL NOTES
- CONTRACTOR SHALL BE RESPONSIBLE FOR PROVIDING ALL NECESSARY FITTINGS AS REQUIRED BY ALL APPLICABLE CODES AND GOVERNING AUTHORITIES.
 - CONTRACTOR SHALL VERIFY AND CORRECT AS REQUIRED TO MEET ALL CODES AND REGULATIONS ANY POSSIBLE DISCREPANCIES BETWEEN TYPE AND SIZE OF CONNECTION SPECIFIED IN PLUMBING FIXTURE SCHEDULE AND FIXTURES ACTUALLY INSTALLED ON THE SITE.
 - SANITARY PIPING 2" SHALL HAVE A 1/4" PER FT. SLOPE. PIPING 3" & LARGER SHALL HAVE A 1/8" PER FT. SLOPE MINIMUM.
 - COORDINATE SANITARY VENTS WITH HVAC O.A. INTAKES. PROVIDE AT LEAST 10'-0" DISTANCE FROM VENT STACKS AND INTAKE VENTS.
 - VALVES AND FITTINGS SHALL BE OF SAME SIZE AND LINE ON WHICH THEY ARE LOCATED, UNLESS OTHERWISE INDICATED ON DRAWING.
 - CONTRACTOR SHALL COORDINATE ALL WORK WITH OTHER TRADES.
 - CONTRACTOR SHALL FIELD VERIFY ALL GIVEN MEASUREMENTS PRIOR TO LAYING AND CONNECTING ALL SANITARY AND WASTE PIPING AND NOTIFY ARCHITECT OF ANY DISCREPANCIES.
 - ALL CHAMBERS SHALL NOT BE CONSIDERED AN EQUAL TO WATER HAMMER ARRESTORS. WATER HAMMER ARRESTORS (WHA) SHALL BE INSTALLED ON ALL GROSS TOILETS AND ON THE BRANCH LINES TO INDIVIDUAL FIXTURES. ALL APPROVED WHAS SHALL BE INSTALLED AS PER STANDARD PDI-WH201. REFER TO PLUMBING FIXTURES SCHEDULE FOR SPECIFICATIONS. PROVIDE ACCESS PANELS IN THE CEILING AS REQUIRED FOR ACCESSIBILITY AND MAINTENANCE. PROVIDE AND INSTALL TYPE "A" ON ALL INDIVIDUAL FIXTURES THAT ARE NOT LOCATED IN GROUP TOILETS OR NOT NOTED ON RISER DIAGRAMS.
 - CONTRACTOR SHALL BE RESPONSIBLE FOR MAINTAINING FIRE RATING AND WEATHERPROOFING INTEGRITY OF ALL PIPING AND PENETRATIONS. REFER TO DETAILS.
 - ALL WATER SUPPLY AND SANITARY LINES SHALL BE RUN AS CLOSE TO PLANS AS POSSIBLE WITH NO CHANGES IN SIZING.
 - CONTRACTOR SHALL BE RESPONSIBLE FOR PROVIDING ALL NECESSARY SUPPORTING DEVICES FOR ALL FIXTURES INCLUDED IN CONTRACT OR HEREIN SPECIFIED OR OTHERWISE.
 - ALL DRAINAGE PIPING SHALL BE MARKED WITH THE SEAL OF APPROVAL OF THE NATIONAL SANITATION FOUNDATION.
 - ROUTE ALL PIPING CONCEALED ABOVE CEILINGS, WITHIN WALLS, OR IN CHASES EXCEPT AS SPECIFICALLY NOTED, OR IN MECHANICAL ROOMS.
 - PROVIDE ACCESS PANELS TO ALL VALVES WITHIN CHASES OR ABOVE NON-ACCESSIBLE CEILINGS. REFER TO ARCHITECTURAL DRAWINGS FOR CEILING TYPES.
 - SEE ARCHITECTURAL DRAWINGS FOR EXACT ROUGH-IN LOCATION OF PLUMBING FIXTURES.
 - PROVIDE A PRE MANUFACTURED DRAIN INSULATING COVER ON ALL SINKS AND LAVATOIRES DESIGNATED AS A HANDICAP FIXTURE. REFER TO PLUMBING DRAWINGS AND THE ARCHITECT'S DRAWINGS FOR DESIGNATIONS.
 - CONTRACTOR SHALL VERIFY INVERT ELEVATIONS OF SEWERS TO WHICH NEW SEWER LINES ARE TO BE CONNECTED BEFORE INSTALLATION OF NEW SEWER LINE.
 - CONTRACTOR SHALL INSTALL DIELECTRIC UNIONS AT CONNECTIONS OF DISSIMILAR METALS.
 - CONTRACTOR SHALL ROUGH-IN ALL WASTES AND SUPPLIES TO SPECIAL EQUIPMENT ACCORDING TO MANUFACTURER'S SHOP DRAWINGS AND MAKE FINAL CONNECTIONS. ALL SUPPLIES SHALL BE VALVED. INSTALL VACUUM BREAKERS WHERE REQUIRED BY CODE.
 - PROVIDE REDUCED PRESSURE BACKFLOW PREVENTERS FOR DOMESTIC WATER SUPPLIES AS REQUIRED BY LOCAL WATER PURVEYORS. PROVIDE THE FOLLOWING BACKFLOW DEVICES IF EQUIPMENT APPLIES TO THIS PROJECT:

| | |
|---|-------------------|
| AUTOCILAVE, STERILIZER, COMMERCIAL DISHWASHING MACHINE, COFFEE URN, COOKING KETTLE, COMMERCIAL GARBAGE DISPOSER | WATTS MODEL #288A |
| BEVERAGE DISPENSING MACHINE, CARBONATED BEVERAGE VENDING MACHINE, COMMERCIAL ICE MACHINE | WATTS MODEL #SD-3 |
 - DO NOT PENETRATE WALL FOOTINGS WITH PIPING, COORDINATE WITH GENERAL CONTRACTOR TO DROP FOOTINGS AS REQUIRED TO CLEAR PLUMBING SERVICES WHERE ABSOLUTELY NECESSARY. ANY PIPING PENETRATING A BEARING WALL OR FOOTING MUST BE SLEEVED AND LOCATION APPROVED BY STRUCTURAL ENGINEER.
 - THE CONTRACTOR SHALL MAKE ALL FINAL CONNECTIONS TO FIXTURES.
 - ASSEMBLE ALL FIXTURES AND EQUIPMENT SHIPPED LOOSE WHICH YOU ARE REQUIRED TO MAKE FINAL CONNECTIONS TO, WHETHER FURNISHED BY YOU OR BY OTHERS, (I.E. WATER FAUCETS, TRIM OR TAILPIECE ETC.).
 - ALL INSTALLATIONS OF FLOOR DRAINS AND HUB DRAINS (LOCATED IN MECHANICAL ROOMS) SHALL COORDINATE WITH THE MECHANICAL EQUIPMENT AND HOUSEKEEPING PADS PRIOR TO ROUGH-IN OF DRAINS.
 - ALL DOMESTIC HOT WATER PIPING AND RECIRCULATED HOT WATER PIPING SHALL BE PROVIDED WITH NOT LESS THAN 1" THICK INSULATION, IN ACCORDANCE WITH SECTION C404.5 OF THE FBC-ENERGY CONSERVATION. REFER TO SPECIFICATION SECTION 22 07 00, PLUMBING INSULATION, FOR MATERIAL AND INSTALLATION REQUIREMENTS.

Order Plans @ www@hww.com

ENGINEERING MATRIX, INC.
 CONSULTING ENGINEERS
 2880 SCRIBNER DRIVE, SUITE 640
 ST. PETERSBURG, FLORIDA, 33716
 (727) 321-4668 FAX (727) 321-4666
 EMAIL: enr@matrixinc.com
 CERT. OF AUTHORIZATION NO. 4898
 © 2019 Engineering Matrix, Inc. DRAWN BY: SCD CHECKED BY: JSW

FleischmanGarcia
 REGISTERED PROFESSIONAL ENGINEERS
 25110 PARK AVENUE, SUITE 300
 TAMPA, FLORIDA 33613
 PHONE (813) 281-4400
 FAX (813) 281-2200
 REGISTRATION NUMBER: AA 000273

Pasco County Fire & Rescue Station No. 17
 New Port Richey, Florida

THIS PERSON AND DRAWING ARE THE SOLE PROPERTY OF FLEISCHMAN-GARCIA AND SHALL NOT BE REPRODUCED OR TRANSMITTED IN ANY FORM OR BY ANY MEANS, WITHOUT THE WRITTEN PERMISSION OF FLEISCHMAN-GARCIA.

FGA PROJECT NUMBER
19039

ISSUE DATE
05-25-20

REVISIONS
 DATE: _____
 DATE: _____
 DATE: _____

SHEET NUMBER
P0.0